



# STATE TOURNAMENT BULLETIN

*PLEASE CHECK BACK OFTEN FOR UPDATES!!!*

---

## TABLE OF CONTENTS

---

CONTENT	PAGE(S)
2024-2025 SOFTBALL IMPORTANT DATES	PAGE 1
GENERAL INFORMATION	PAGE 2
SITE INFORMATION	PAGES 3-4
MEDIA & STATE TOURNAMENT HOTEL INFORMATION	PAGE 5
STATE TOURNAMENT GAME SCHEDULE	PAGE 6
LHSAA/GOFAN TICKET SELF-CHECKOUT INSTRUCTIONS AND QR CODE	PAGE 7
STATE TOURNAMENT LOCATIONS & DIRECTIONS	PAGE 8
NORTH FRASCH SOFTBALL COMPLEX LAYOUT	PAGE 9
CHAMPIONSHIP SOUVENIRS	PAGE 10
LHSAA SPONSORS	PAGES 11

*Due to construction in the area Teams and Spectators need to check traffic conditions @ [LA DOTD](#) to allow for enough time to reach tournament site.*

---

## 2024-25 SOFTBALL IMPORTANT DATES

---

*This Bulletin is for your benefit. Please read and make sure all necessary parties receive the correct information concerning the event.*

DATE	EVENT
Tuesday, April 15, 2025 By 10:00 PM <i>(LHSAA Bylaw 19.6.1)</i>	Deadline to submit report District Champion online.
Wednesday, April 16, 2025 <i>(LHSAA Bylaw 6.12.6)</i>	Playoff Pairings Named/Brackets Released and Unofficial Dispute Period.
Friday, April 18, 2025 <i>(LHSAA Bylaw 6.13.6 &amp; LHSAA Bylaw 19.11.8)</i>	Deadline to Submit Program Roster Information. Roster form instructions can be found <a href="#">here</a> .

**Softball Playoff Dates - All Divisions:**

Bi-District Round - Saturday, April 19, 2025  
Regional Round - Wednesday, April 23, 2025  
Quarterfinal Round - Saturday, April 26, 2025

**LHSAA State Softball Tournament**

**Semifinals:** Friday, May 2, 2025  
**Finals:** Saturday, May 3, 2025  
North Frasch Softball Complex, Sulphur, LA

***Due to construction in the area Teams and Spectators need to check traffic conditions @ [LA DOTD](#) to allow for enough time to reach tournament site.***

## 2024-25 STATE TOURNAMENT GENERAL INFORMATION

CATEGORY	DATE/INFORMATION
State Tournament- Dates/Site	Friday, May 2 <sup>nd</sup> – Saturday, May 3 <sup>rd</sup> , 2025 <a href="#">North Frasch Softball Complex   Sulphur, LA</a>
Tournament Director	Karen Hoyt, LHSAA Assistant Executive Director Email: <a href="mailto:khoyt@lhsaa.org">khoyt@lhsaa.org</a> Office: (225) 300-4215
Assistant to Tournament Director	S. Lacy Macdiarmid, LHSAA Administrative Assistant Email: <a href="mailto:lmacdiarmid@lhsaa.org">lmacdiarmid@lhsaa.org</a> Office: (225) 300-4208
Sulphur Parks & Rec.	933 W. Parish Rd., Sulphur, LA 70663 (337) 527-2500
Admission <b>(CASH ONLY Concessions)</b>	Sold exclusively through the GoFan website <a href="#">here</a> . General Admission Ticket - \$18.00 + GoFan Convenience Fee Concessions at SPAR are <b><u>CASH ONLY</u></b> <b><u>Tickets will <i>not</i> be sold or accepted at North Frasch Softball Complex on the day of the games. Please show your mobile device to redeem your tickets.</u></b> <b><u>THERE IS <i>NO RE-ENTRY</i> AFTER THE TICKET HAS BEEN REDEEMED</u></b>
LHSCA Coaches Gate	North Gate of North Frasch Softball Complex. (see map on page 9) <b><u>ALL LHSCA/LHSAA CARDS ARE NON-TRANSFERABLE</u></b> <b><u>CARDHOLDERS MUST BE PRESENT WITH A VALID PICTURE ID</u></b>
Trainers/ Medical Personnel/ Other	Trainers and bottled water will be provided for all games. Schools must bring their own tape and individual water bottles that do not conflict with LHSAA Partner Powerade. Teams are encouraged to bring their own water. Official Game Ball – Baden Perfection 2BSFPY (Optic Yellow) 2025 National Federation Softball Playing and LHSAA Rules will be followed.

## 2024-25 STATE TOURNAMENT SITE INFORMATION

CATEGORY	DATE/INFORMATION
Team Buses & Parking	Please see the map on page 9 of this bulletin.
<p>Team Information:                      -Drop-off &amp; Entry                      - Team &amp; Individual Pictures  <i>The roster bylaw will be strictly enforced.</i></p>	<p>Each team shall enter through the Team Gate listed on page 9 of this bulletin.</p> <p>Each team will be allowed to enter 35 personnel. The 35 include coaches, players in legal uniform, managers, trainers, and statisticians. Additional team personnel shall purchase a ticket and enter through either the North or South Gates. <b><u>ZERO EXCEPTIONS!! (LHSAA Bylaw 19.11.8)</u></b></p> <p><b><u>FRIDAY ONLY</u></b> - Team and individual pictures will be taken upon team arrival on Field #20. GeauxPreps requests that all teams arrive in game uniform 2 hours prior to the game.</p> <p><b><u>SATURDAY</u></b> - Teams may enter the facility 1 hour prior to the game.</p>
Practice Fields	Scheduled Practice time will be available for Thursday, May 1, 2025, at Pattison Park. Contact SPAR @ <a href="mailto:sports@sulphurparks.com">sports@sulphurparks.com</a> or 337-527-2500 to schedule no later than 5:00 p.m. Wednesday, April 30, 2025.
<p>Game Fields  <i>All Seeded and Shelled Food Products Are Strictly Prohibited</i></p>	<p>All game fields have turf infields, including the pitcher's mound and home plate with natural grass outfields.</p> <p><b><u>NO PLAYERS WILL BE ALLOWED TO WEAR METAL/STEEL CLEATS!</u></b></p>
Team Dugouts	The home team (higher seed) shall occupy the third base dugout, and the visiting team shall occupy the first base dugout. <b><u>(LHSAA Bylaw 6.13.9)</u></b>
Infield Warmup	Each team will be allowed 10 minutes of infield prior to the game. The home team shall take the infield first, followed by the visiting team.
Warm & Walk-Up Music	Walk up music is not permitted at the state tournament.
Team Post-Game Protocol	<b><u>Finals:</u></b> Both schools are required to remain on the field, participate in the awards ceremony until its completion and cooperate and attend. Failure to do so will result in the offending school being fined. <b><u>(LHSAA Bylaw 5.11.28)</u></b>
Team Meals/Travel Stipend	<p>-Must be in uniform and present ticket at concession stand, see map on page 9. (Includes a hot food item, chips, drink/<i>Friday-Semifinal Rounds Only</i>)</p> <p>-Each participating Team will receive a \$400 travel stipend that will be mailed to school at the conclusion of the event.</p>
<p>Travel Information  <a href="#">LA DOTD</a></p>	Due to construction in the area, Teams and Spectators need to check traffic conditions @ <a href="#">LA DOTD</a> to allow for enough time to reach tournament site.

2024-25 STATE TOURNAMENT SITE INFORMATION  
CONTINUED

CATEGORY	DATE/INFORMATION
Rain Delays/Postponements/ Rain Check Vouchers	The tournament director has the sole jurisdiction to postpone and/or cancel the start of a/the game. Once the umpire's jurisdiction begins, they have the sole authority to suspend a/the game due to inclement weather. Games are scheduled on a day-to-day basis including Sunday, if necessary. ( <a href="#"><u>Bylaw 6.15.2</u></a> ) Rain check vouchers will be available through GoFan.
Tournament Program	Event Program will be provided via QR code posted at site.
All-Academic Recipients	Your student will be recognized by printing the certificate and honoring the student at your sports award banquets. If you have any questions, please contact Renee' Ballard at <a href="mailto:rballard@lhsaa.org"><u>rballard@lhsaa.org</u></a> .
Non-Participating Teams	Any team that has played a semi-final game and is no longer participating in the tournament shall be accompanied by their head coach, listed on schools submitted roster and enter together at the Team Entrance to enter free of charge.
North Frasch Softball Complex Prohibited Items	<p><b><u>Including, but not limited to, the fields, dugouts, and bleachers:</u></b></p> <ul style="list-style-type: none"> <li>▪ Outside Food &amp; Beverages (Concessions are available)</li> <li>▪ Alcohol</li> <li>▪ All Seeds and Shelled Food Products</li> <li>▪ Gum</li> <li>▪ Any and All Air Horns, Confetti, Confetti guns, Etc.</li> <li>▪ Tobacco Products (Including but not limited to vapors and smokeless products)</li> </ul> <p><b><i>Any/all unauthorized items shall be confiscated immediately</i></b></p>
LHSAA School Supervision, Responsibilities, Prohibited Items & Policies	<p><b><u>Schools shall be responsible for including but not limited to the following:</u></b></p> <ul style="list-style-type: none"> <li>- <a href="#"><u>LHSAA Administration/Sportsmanship Bylaws</u></a></li> <li>- <a href="#"><u>LHSAA Prohibited Items</u></a></li> <li>- <a href="#"><u>LHSAA Shirt and Shoe Policy</u></a></li> <li>- Informing all their athletes, students, fans, etc. of any/all LHSAA and/or North Frasch Softball Complex prohibited items, policies, etc.</li> </ul> <p>Failure to do so shall result in the offending school being fine.</p>
Animals/Pets/Live Mascots Policy	<p><b><u>ONLY</u></b> ADA Service Animals shall be allowed in North Frasch Softball Complex.</p> <ul style="list-style-type: none"> <li>- <a href="#"><u>Americans with Disabilities Act (ADA) Service Animal Definition</u></a></li> </ul> <p>Any/all animals, including but not limited to, live mascots of any kind are <b><i>strictly prohibited. ZERO EXCEPTIONS!!</i></b></p>

**2024-25 STATE TOURNAMENT  
MEDIA & BROADCASTING INFORMATION**

CATEGORY	DATE/INFORMATION
Media/Radio/ Internet Broadcasting & Game Video	<ul style="list-style-type: none"> <li>- For any/all media information and questions, please contact Ethan Anderson @ <a href="mailto:eanderson@lhsaa.org">eanderson@lhsaa.org</a>.</li> <li>- LHSAA News &amp; Media <a href="https://www.lhsaa.org/media">https://www.lhsaa.org/media</a></li> <li>- <a href="#">LHSAA Media Guidelines</a></li> </ul>
Broadcasting & Game Video	<ul style="list-style-type: none"> <li>- NFHS Network will be broadcasting and live streaming the entire tournament.</li> <li>- Live streaming of any kind is strictly prohibited during the entirety of the championships. Fines shall be levied against any person/persons attending school caught live streaming without written consent from the LHSAA.</li> </ul>

**2024-25 STATE TOURNAMENT HOTEL INFORMATION  
*FOR PARTICIPATING TEAMS ONLY***

**HOTEL SUPERVISION**

- Teams must be supervised at all times! The school will be responsible for any damage to assigned rooms or hotels and their property.

**HOTEL INFORMATION**

2025 LHSAA Softball State Championship  
Hotel Information

HOTEL	RATE	PHONE
Best Western PLUS Executive Hotel & Suites	\$114.00	337-625-9000
Best Western Plus Prien - Lake Charles	\$139.00	337-477-5900
Candlewood Suites Lake Charles South	\$123.00	337-478-8008
Clarion Pointe	\$110-\$120	337-313-6018
Comfort Suites Lake Charles	\$95-\$105	337-660-2483
DoubleTree by Hilton	\$149.00	337-527-0858
Golden Nugget Lake Charles	\$129-\$279	844-777-4653
Hampton Inn by Hilton Sulphur/Lake Charles Area	\$139.00	337-527-0000
Hampton Inn Lake Charles	\$144.00	337-480-6443
Hawthorne Suites Sulphur	\$99-\$104	337-287-9675
Heritage Suites Dequincy	\$98-\$110	337-786-2919
Holiday Inn & Suites Sulphur (Lake Charles)	\$149.00	337-625-2500
Home 2 Suites Lake Charles	\$149-\$159	337-990-5330
Laquinta Sulphur	\$139-\$149	337-287-9674
Quality Inn & Suites Lake Charles	\$89-\$99	337-480-0898
Red Roof Inn Sulphur	\$90-\$94	337-527-1100
Springhill Suites by Marriott- Lake Charles	\$149.00	337-474-1112
Staybridge Suites Lake Charles	\$139-\$159	337-477-7474
The Marco Hotel Lake Charles	\$109-\$114	337-439-2444
Tru by Hilton Lake Charles	\$139.00	337-513-5113
Wingate by Wyndham Sulphur	\$130-\$150	337-527-5151
Wingate by Wyndham Lake Charles	\$129.00	337-426-0366
Visit Lake Charles		1-800-456-7952

---

## 2024-25 STATE TOURNAMENT GAME SCHEDULE

---

*As official games are scheduled, field assignments will be updated on each individual online bracket.*

SEMI-FINALS – Friday, May 2 <sup>nd</sup>			
FIELD	12:00 PM SESSION	2:30 PM SESSION	5:00 PM SESSION
13	S III	NS II	S I
14	S III	NS II	S I
15	NS III	S II	S IV
16	NS III	S II	S IV
17	B	NS IV	NS I
18	B	NS IV	NS I
19	C	C	
20	<i>PICTURES</i>	<i>PICTURES</i>	<i>PICTURES</i>

FINALS – Saturday, May 3 <sup>rd</sup>		
FIELD	12:00 PM SESSION	3:00 PM SESSION
13	C	S IV
14	NS III	S II
15	NS IV	S I
16	B	NS II
17	S III	NS I
18		
19		



# BUY TICKETS HERE

SELF CHECKOUT



1. Open Phone Camera
2. Hover Over QR Code
3. Access GoFan Website

1 SEARCH FOR SCHOOL

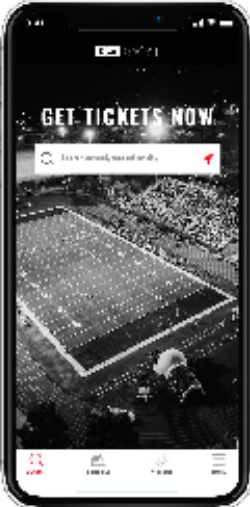

2 SELECT EVENT AND TICKETS



3 BUY TICKETS



4 CLICK "VIEW TICKETS" AND PRESENT AT GATE



# State Tournament Locations & Directions

**1** Rec & Aquatic Center

**2** Frasch Park & Golf Course

**3** North Frasch Park

**Tournament Site**

**4** Hopye's

**5** Pattison Park

**Warm-Up & Practice Sites**

**6** Kroger

**7** McMurry Park

**8** Capital One

**9** Wal-Mart

**10** North Frasch Complex

**11** Pattison Park

**12** Rec & Aquatic Center/Waterpark & Administrative Offices

**Map Details:**  
 HWY 90, HWY 27 N, Church, N Huntington, Hospital, Cypress St, Logan St, Parish Rd, Ruth St, Hazel St, Circle K, Maplewood Dr, Cites Service Hwy, Interstate 10, Exit 20, Exit 21, Exit 23, 210 Loop to Lake Charles, HWY 108, Interstate 10 to Lake Charles.

**1** Rec & Aquatic Center/Waterpark & Administrative Offices  
 933 W Parish Rd Sulphur, LA 70663  
 337-527-2500  
 Exit 20 Travel north on Ruth St for 0.55 mi. Turn left on Parish Rd for 0.62 mi. Rec & AQ Center/Waterpark is on left.

**3** North Frasch Complex  
 400 Picard Rd Sulphur, LA 70663  
 Exit 20 Travel north on Ruth St for 0.55 mi. Turn left on Parish Rd for 0.58 mi. Turn right on Picard Rd 0.54 mi for south entrance on left & 0.75 mi for north entrance on left.

**5** Pattison Park  
 1400 Picard Rd Sulphur, LA 70663  
 Exit 20 Travel north on Ruth St for 0.55 mi. Turn left on Parish Rd for 0.58 mi.

**Icons:** softball, restrooms, picnic, baseball, Play Structures, walking.

# North Frasch Complex Field Layout

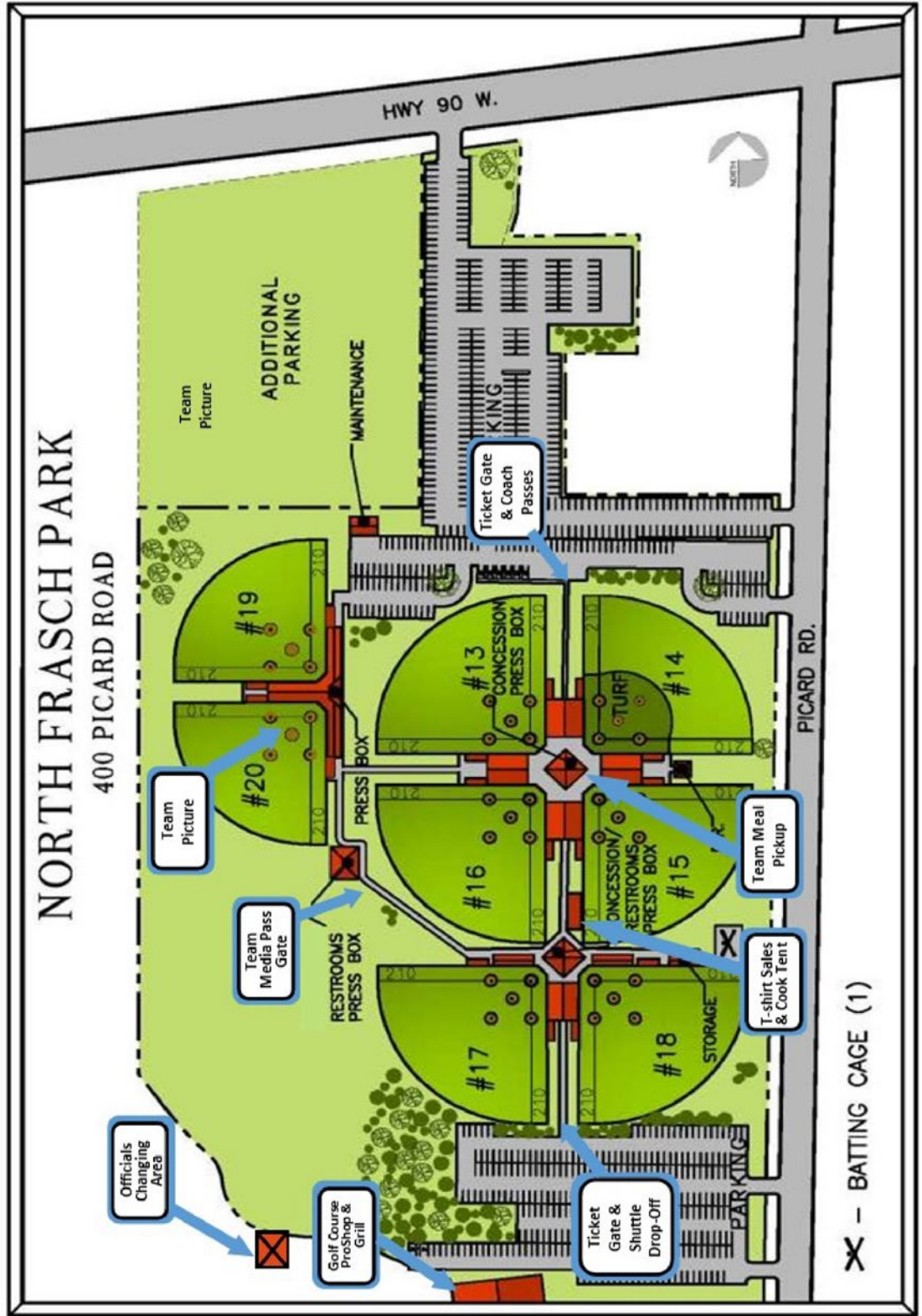

---

## 2024-25 CHAMPIONSHIP SOUVENIRS

---

### CHAMPIONSHIP APPAREL



Remember this achievement. Visit the PepWear Store or [shop.lhsaa.org](http://shop.lhsaa.org) to purchase Official Event Merchandise including shirts and hoodies with participants' names on the back, full color plaques, and more!

For assistance with orders contact (866) 775-3450 or [customerservice@pepwear.com](mailto:customerservice@pepwear.com)

### CHAMPIONSHIP PHOTOGRAPHS



GeauxPreps is proud to be the official photographer of the Louisiana High School Athletic Association. Please stop by our booth during all of the LHSAA Championships to view and order photos. Team and individual, action, and all awards photos will be available for purchase and will be printed on site.

<https://geauxpreps.com/photos/>

### CHAMPIONSHIP RINGS



Congratulations champions! Celebrate your victory with your championship ring- the ultimate symbol of dedication, perseverance, and teamwork. Herff Jones is proud to be the exclusive provider for LHSAA and LHSCA Championship Jewelry and is the recognized leader in celebrating student milestones.

Harris Beall, Clint Ivey, Donald Scamardo

Baton Rouge, LA // 225.927.1383 // [gshhbrla@gradsupply.biz](mailto:gshhbrla@gradsupply.biz)  
Metairie, LA // 504.737.4439 // [gradsupply@aol.com](mailto:gradsupply@aol.com)

### CHAMPIONSHIP REPLICA TROPHIES



For more information regarding State Championship mini replica trophies and medals, contact Gold Star Trophies at (225) 928-4230.

[www.goldstartrophies.com](http://www.goldstartrophies.com)

2024-25 LHSAA SPONSORS



## LHSAA CORPORATE PARTNERS

THE LHSAA WOULD LIKE TO THANK THE FOLLOWING 2024-2025 PARTNERS FOR THEIR CONTINUED DEDICATION & SUPPORT OF HIGH SCHOOL ATHLETICS IN LOUISIANA



SERVING LOUISIANA'S YOUTH FOR **OVER 100 YEARS**

IF YOU ARE INTERESTED IN PARTNERING WITH THE LHSAA OR FOR MORE INFORMATION PLEASE CONTACT WES BAYLOR - WES@LHSAASP.COM